

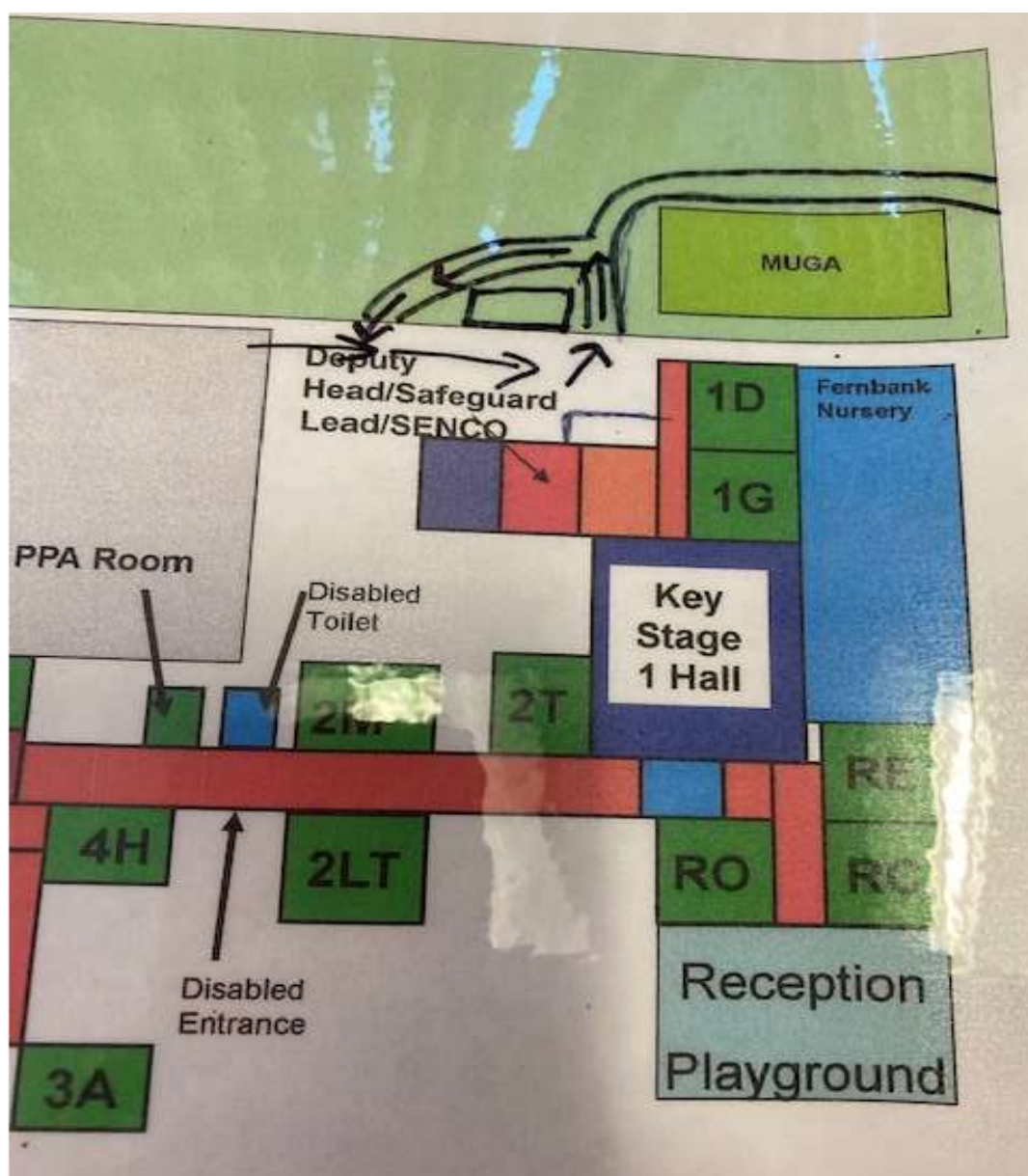

## WAY IN AND OUT FROM LAMMACK ROAD

- Enter from the red double gates on Lammack Road and walk straight ahead along the path.
- Continue walking along the path between the outdoor stage and the green shed.
- Once you have dropped your children, turn left on to the path between the green shed and the Muga (as marked in black on the route below).
- Keep to the right once on to the Junior playground and leave the premises by the single red gate, which leads back on to Lammack Road.





## WAY IN AND OUT FROM WHINNEY LANE

- Follow the path down Whinney Lane.
- Reception parents, branch to left to reach the Infant playground.
- **All other parents**, branch to the right and follow the path around the Muga (**only** nursery parents can go straight ahead)
- Enter the Muga and cross the pitch towards the glass corridor (as highlighted below).
- After dropping children, walk back up the main path, passing Fernbank on the right and back up to Whinney Lane (as highlighted below).

